

# *Sunbeam*

## CitrusPress

### User Guide

JEM1000SS



## Contents

Sunbeam's Safety Precautions	1
Features of your Sunbeam CitrusPress	2
Using your Sunbeam CitrusPress	4
Care and Cleaning	5

## Important Instructions - retain for future use

تأكد من تفهم احتياطات السلامة المذكورة اعلاه

請務必理解上述的安全預防措施。

Assurez-vous que les précautions ci-dessus relatives à la sécurité sont bien comprises

Versichern Sie sich daß die obenstehenden Sicherheitsmaßnahmen Verstanden werden

Βεβαιώσετε πως οι παραπάνω προφυλάξεις ασφαλείας γίνονται κατανοητές

Pastikan bahwa tindakan-tindakan keselamatan seperti di atas dimengerti anda

Accertatevi che le suddette norme di sicurezza siano comprese a dovere

上記の注意事項をよくお読みになり、安全を御確認ください

Уверете се дека погоре споменатите мерки на претпазливост се добро разбрани

Aségúrese de que las precauciones de seguridad precedentes sean bien comprendidas

کاری بکنید کہ احتیاطهای بالا حتماً درک بشوند

ต้องแน่ใจว่า ข้อควรระวังเรื่องความปลอดภัยข้างต้น เป็นที่เข้าใจกันดี

Yukarda belirtilen güvenlik önlemlerinin anlaşıldığından emin olunuz

Xin kiểm chắc rằng những biện pháp làm an toàn kể trên được hiểu rõ

## Sunbeam's Safety Precautions

SAFETY PRECAUTIONS FOR YOUR CITRUSPRESS.

- Handle the moving parts of the device with extreme care and caution.
  - Switch power outlet off and unplug before cleaning.
- Sunbeam is very safety conscious when designing and manufacturing consumer products, but it is essential that the product user also exercise care when using an electrical appliance. Listed below are precautions which are essential for the safe use of an electrical appliance:**
- Read carefully and save all the instructions provided with an appliance.
  - Always turn the power off at the power outlet before you insert or remove a plug. Remove by grasping the plug - do not pull on the cord.
  - Turn the power off and remove the plug when the appliance is not in use and before cleaning.
  - Do not use your appliance with an extension cord unless this cord has been checked and tested by a qualified technician or service person.
  - Always use your appliance from a power outlet of the voltage (A.C. only) marked on the appliance.
  - This appliance is not intended for use by persons (including children) with reduced physical, sensory or mental capabilities, or lack of experience and knowledge, unless they have been given supervision or instruction concerning use of the appliance by a person responsible for their safety.
  - Children should be supervised to ensure that they do not play with the appliance.
  - The temperature of accessible surfaces may be high when the appliance is operating.
  - Never leave an appliance unattended while in use.
  - Do not use an appliance for any purpose other than its intended use.
  - Do not place an appliance on or near a hot gas flame, electric element or on a heated oven.
  - Do not place on top of any other appliance.
  - Do not let the power cord of an appliance hang over the edge of a table or bench top or touch any hot surface.
  - Do not operate any electrical appliance with a damaged cord or after the appliance has been damaged in any manner. If damage is suspected, return the appliance to the nearest Sunbeam Appointed Service Centre for examination, repair or adjustment.
  - For additional protection, Sunbeam recommend the use of a residual current device (RCD) with a tripping current not exceeding 30mA in the electrical circuit supplying power to your appliances.
  - Do not immerse the appliance in water or any other liquid unless recommended.
  - Appliances are not intended to be operated by means of an external timer or separate remote control system.
  - This appliance is intended to be used in household and similar applications such as: staff kitchen areas in shops, offices and other working environments; farm houses; by clients in hotels, motels and other residential type environments; bed and breakfast type environments.

If you have any concerns regarding the performance and use of your appliance, please visit [www.sunbeam.com.au](http://www.sunbeam.com.au) or [www.sunbeam.co.nz](http://www.sunbeam.co.nz) contact the Sunbeam Customer Service Line. Ensure the above safety precautions are understood.

## Features of your Sunbeam CitrusPress

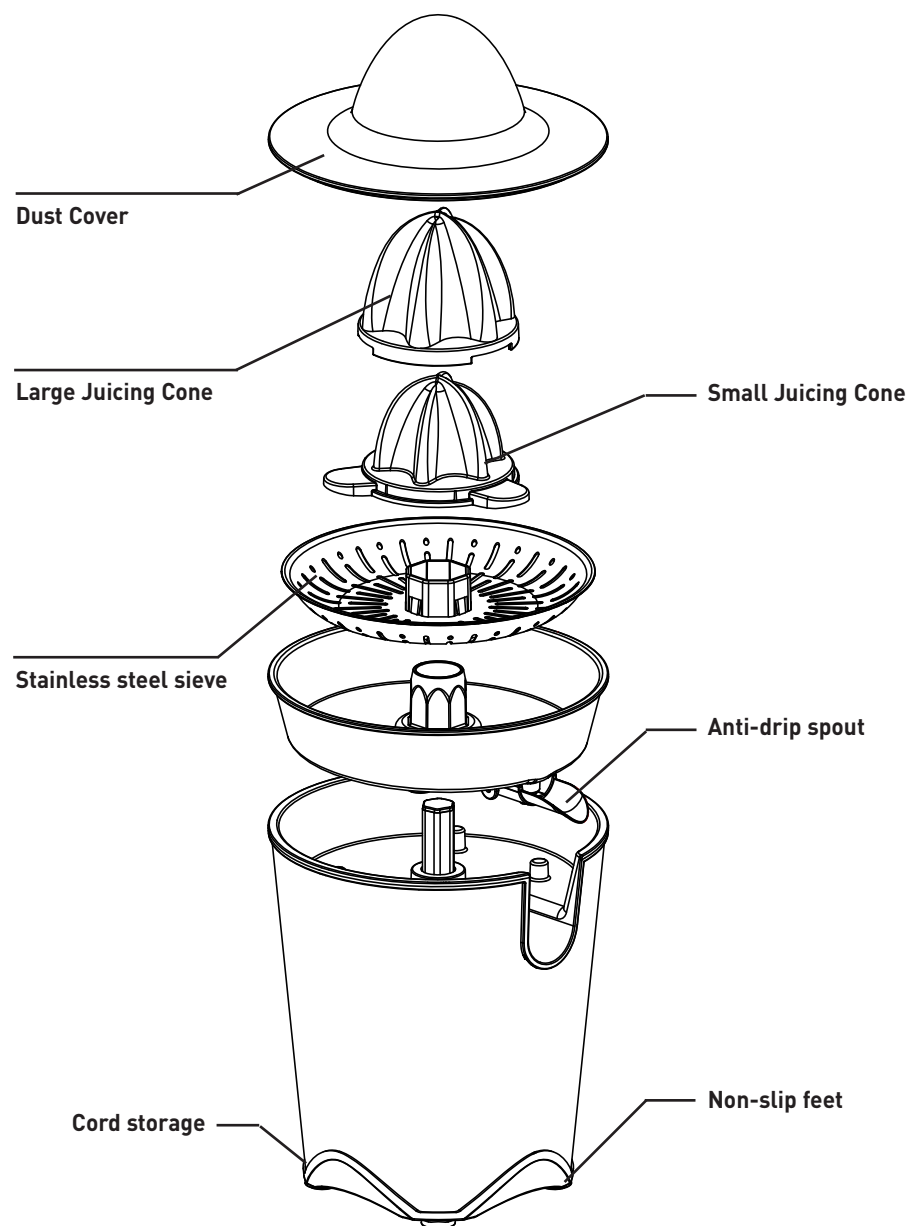

## Features of your Sunbeam CitrusPress (continued)

### Dust cover

For use when the CitrusPress is in storage and not in use.

### Large Juicing Cone

Extracts juice from large citrus fruits, such as oranges and grapefruits.

### Small Juicing Cone

Extracts juice from small citrus fruits, such as lemons and limes.

### Automatic start/stop operation

To start the juicer simply push the fruit onto the juicing cone, it stops automatically when you release the pressure.

### Stainless steel sieve

Separates the pulp and ensures you get fresh, smooth juice.

### Cord Storage

Excess cord can be wound around the storage facility underneath the CitrusPress.

### Anti-drip spout

The anti-drip spout, when flipped down, allows fresh juice to pour directly into your glass. To stop the flow or to place another glass, simply push the anti-drip spout upwards. This will stop the flow of juice without spilling a single drop.

### Non-slip feet

Ensures the CitrusPress remains stable on the benchtop for your safety and convenience.

## Using your Sunbeam CitrusPress

### Before using your CitrusPress

Clean the juicing cones, stainless steel sieve and juice container in warm soapy water. Rinse and dry thoroughly. Alternatively you can place these parts in the upper section of your dishwasher.

### Using your CitrusPress

1. Position the stainless steel sieve onto the juicing container and place onto the motor base.
2. Place the small juicing cone onto the drive shaft. If you are juicing larger citrus fruits, position the larger juicing cone over the smaller juicing cone so the large cone is sitting on top of the smaller cone.
3. Plug the power cord of the CitrusPress into a 230-240V AC power outlet and switch the power on.
4. Place a glass under the anti-drip spout.
5. To open the anti-drip spout, push it downwards to allow the juice to flow into the glass.
6. Cut the citrus segments in half, cutting across the segments.

---

**NOTE:** Before juicing we recommend that you roll the fruit on the bench whilst pressing down gently. This way you will obtain more juice.

---

7. Press a fruit half onto the juicing cone – the CitrusPress starts automatically and stops when the fruit is removed.
8. Push the anti-drip spout upwards to stop the flow of juice, you can then remove or exchange the full glass with another – this ensures that the anti-drip spout does not allow the juice to continue to flow.
9. When the CitrusPress is no longer needed, remove the power cord from the power outlet and clean the CitrusPress – see “Care and Cleaning” on page 5.

## Care and Cleaning

---

**NOTE:** Before cleaning always remove the power cord from the power outlet. Remove the juicing cones, stainless steel sieve and juicing container from the motor part of the base of the CitrusPress. Clean all parts with warm soapy water. Rinse and dry thoroughly.

---

**NOTE:** For thorough cleaning of the anti-drip spout, it can be removed from the juicing container. This ensures that any residue remaining from the juice is removed.

---

Alternatively you can place these parts in the upper section of your dishwasher.

Clean the motor base of the CitrusPress with a damp cloth. Never use harsh cleaning or scouring agents. Never immerse in water or other liquids.

## Warranty



This Sunbeam product is covered by a 12 month replacement or repair warranty, which is in addition to your rights under the Australian Consumer Law (if your product was purchased in Australia) or New Zealand Consumer Guarantees Act (if your product was purchased in New Zealand).

Upon receipt of your claim, Sunbeam will seek to resolve your difficulties or, if the product is defective, advise you on how to obtain a replacement or refund.

To assist us in managing warranty claims, we recommend you register your product as soon as practicable after purchase by creating a MySunbeam account on our website and uploading a copy of your original receipt.

In order to make a claim under our warranty, you must have the original proof of purchase documentation for the product and present it when requested (if not already uploaded to our website).

Should your product develop any defect within 12 months of purchase because of faulty materials or workmanship, we will replace or repair it, at our discretion, free of charge. A product presented for repair may be replaced by a refurbished product of the same type rather than being repaired. Refurbished parts may be used to repair the product.

Our replacement or repair warranty only applies where a defect arises as a result of faulty material or workmanship during the warranty period. Your warranty does not cover misuse or negligent handling (including damage caused by failing to use the product in accordance with this instruction booklet), accidental damage, or normal wear and tear.

Your warranty does not:

- cover freight or any other costs incurred in making a claim, consumable items, accessories that by their nature and limited lifespan require periodic renewal (such as filters and seals) or any consequential loss or damage; or

- cover damage caused by:
  - power surges, power dips, voltage supply problems, or use of the product on incorrect voltage;

- servicing or modification of the product other than by Sunbeam or an authorised Sunbeam service centre;
- use of the product with other accessories, attachments, product supplies, parts or devices that do not conform to Sunbeam specifications; or
- exposure of the product to abnormally corrosive conditions; or

- extend beyond 3 months if the product is used in commercial, industrial, educational or rental applications.

**The benefits given to you by our warranty are in addition to other rights and remedies under law in relation to the product.**

**In Australia our goods come with guarantees that cannot be excluded under the Australian Consumer Law. You are entitled to a replacement or refund for a major failure and for compensation for any other foreseeable loss or damage. You are also entitled to have the goods repaired or replaced if the goods fail to be of acceptable quality and the failure does not amount to a major failure.**

**Our goods also come with guarantees that cannot be excluded under the New Zealand Consumer Guarantees Act.**

If your warranty claim is not accepted, we will inform you and if requested to do so by you, repair the product provided you pay the usual charges for such repair. You will also be responsible for all freight and other costs.

Should your product require repair or service after the warranty period, contact your nearest Sunbeam service centre. For a complete list of Sunbeam's service centres, visit our website or call our customer care line for advice on: 1300 881 861 in Australia, or 0800 786 232 in New Zealand.

Should you experience any difficulties with your product during the warranty period, please contact Sunbeam Customer Care:

**Australia**  
www.sunbeam.com.au  
1300 881 861  
Suite 1, Level 1,  
13 Lord Street,  
Botany NSW 2019  
Australia

**New Zealand**  
www.sunbeam.co.nz  
0800 786 232  
Level 6, Building 5,  
Central Park,  
660-670 Great South Road  
Greenlane, Auckland  
New Zealand

# Sunbeam

## Need help with your appliance?

Contact our Customer Care Team or visit our website for information and tips on getting the most from your appliance.

### AUSTRALIA

Visit: [www.sunbeam.com.au](http://www.sunbeam.com.au)  
Phone: 1300 881 861  
Mail: Suite 1, Level 1, 13 Lord Street,  
Botany NSW 2019

### NEW ZEALAND

Visit: [www.sunbeam.co.nz](http://www.sunbeam.co.nz)  
Phone: 0800 786 232  
Mail: Level 6, Building 5, Central Park,  
660–670 Great South Road,  
Greenlane, Auckland



– APPROVED BY –



NEWELL AUSTRALIA PTY LTD ABN 68 075 071 233

Due to continued product improvements, product illustrations and photographs in this User Guide may differ slightly from the actual product.